

---

# MILLIE SUMMERS TRAVEL

---

## Small Group Trip To Kenya, A Watercolour Painting Safari with Hazel Soan



A nine day (eight night), dedicated wildlife painting safari to Samburu, [Kenya](#). The safari is exclusive to 10 guests who will have the hugely successful artist Hazel Soan guiding them on a water colour journey into the wild African bush.

**8<sup>th</sup> – 16<sup>th</sup> March 2025**

**Summary:**

- 8<sup>th</sup> March 2025:** 1 night at the Tamarind Tree Hotel, Nairobi (B&B)
- 9<sup>th</sup> March 2025:** 7 nights Soroi Larsens Camp (Full Board), Samburu National Reserve
- 16<sup>th</sup> March 2025:** Day room at Four Points Sheraton, Jomo Kenyatta International Airport & depart Kenya



Millie Summers Travel operates its holiday packages through Hemisphere Travel Group. Hemisphere Travel Group are ATOL protected (T7550) and a member of the Travel Trust Association (TTA) Q3174, giving 100% Financial Protection for all elements of your holiday.

## Hazel Soan



Hazel Soan is one of Britain's most admired watercolourists. She has gained a reputation as one of the leading wildlife painters in watercolour and is a regular judge for The DSWF *Wildlife Artist of the Year*.

Hazel's direct wet-into-wet watercolour approach and fascination with pigments and their properties largely developed in the African Bush, where she returns often to paint the animals she loves. Her main inspiration is the shapes and patterns made by strong and subtle contrasts of light and shade for which Africa is renowned.

She is known through her numerous books, DVD films and television roles such as *Watercolour Challenge* and *Splash of Colour*. Hazel's work is held in public, private and corporate collections, including the National Portrait Gallery, BBC Television and BP, along with several embassies, major London hospitals and hotels, finance houses and countless private homes worldwide.

With a natural ability to communicate her passion for watercolour, Hazel has become much in demand for workshops and painting holidays, particularly in the African bush. Her enthusiasm, patience and ability to inspire others to paint has taken her from the Kalahari to the QE2, cities to shorelines, remote kraals to Royal palaces. She has studios in London and Cape Town and shows her work regularly.

On this trip you will paint on the early morning and late afternoon game drives and then back at camp Hazel will be able to give you tuition before lunch.



**Saturday, 8<sup>th</sup> March, 2025**



Suggested flight if coming from the UK:

British Airways: BA 0065 – London Heathrow to Jomo Kenyatta International Airport, Nairobi – 09.50 – 21.30.

Upon arrival at Jomo Kenyatta International Airport you will be met and driven to the nearby Tamarind Tree Hotel. You will spend the night here on a Bed & Breakfast basis.

#### **Tamarind Tree Hotel, Nairobi**

##### **1 night (B&B)**

Perfectly situated in between Nairobi's two airports (15 minutes from Jomo Kenyatta International Airport on the new dual carriageway), the Tamarind Tree Hotel is a modern concept hotel, imbued with an African flavour which will incorporate innovative features to suit the needs of the business and leisure travellers. The 162 rooms have all the amenities of a modern hotel: spacious rooms, excellent free wi-fi, satellite TV plus a gym and heated lap pool. The public areas are a blend of social and relaxation zones with a 24-hour grab and go food duka (shop) along with all day dining and bars. The world renowned Carnivore restaurant will be an additional attraction that can be accessed by way of a nature trail through the expansive grounds of the property.

**Sunday, 9<sup>th</sup> March, 2025**

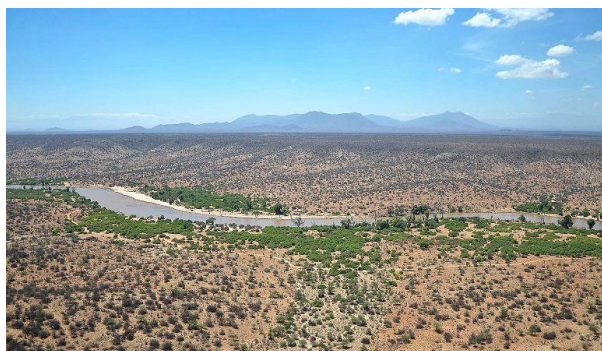

This morning you will be picked up from the hotel and driven to Nairobi's domestic Wilson Airport.

Here you will fly from Wilson to Samburu's National Park airstrip in Samburu (normally around 10.20-11.20).

These scheduled flights are normally in 12 seater Cessna Caravans on safari. They may touch down to drop off/pick up other passengers at airstrips en route.

**There is a strict luggage limit of 15kg per person, including hand luggage, and it must be packed in soft bags (no hard sides). A separate vehicle will take any excess luggage required to Samburu by road.**

You'll be met at the airstrip in Samburu and driven to Larsens Tented Camp, no doubt stopping to look at some wildlife along the way. You will settle into your tents and have lunch before heading out on an afternoon game drive.

#### **Samburu**

The Samburu National Reserve is less well-known than other parks in Kenya but it offers a unique ecosystem with an area that is much drier than southern regions and the more well known Masai Mara – the animals are more able to cope with desert-lifestyle. Famous for the Samburu Special Five



Millie Summers Travel operates its holiday packages through Hemisphere Travel Group. Hemisphere Travel Group are ATOL protected (T7550) and a member of the Travel Trust Association (TTA) Q3174, giving 100% Financial Protection for all elements of your holiday.



(Grevy's zebra, Somali ostrich, reticulated giraffe, gerenuk and the beisa oryx) the area is also home to over 450 bird species and 75 mammal species including elephants and the big cats.

The Ewaso Nyiro river flows through the Samburu National Reserve, through picturesque doum palm groves and thick riverine forests. It provides a much valued source of water in this semi-arid area, without which the wildlife in this region could not survive.

March is nearing the end of their summer months so the dwindling river becomes the hub of wildlife activity as the water becomes more and more scarce before the long rains are due to start in April/May. So it is not unusual to have wonderful elephant and wildlife sightings whilst sitting and enjoying the river view from your own private deck.

The Samburu are a semi-nomadic sub-tribe of the Maasai and they have their own dialect of the Maa language. They are known for their traditional lifestyle, which includes religious beliefs, rituals and colourful tribal clothing and beading all largely unchanged by Western influences.

#### **Larsens Tented Camp, Samburu National Park 7 nights (Full Board)**

With an illustrious legacy rooted in exploration and natural wonder, Larsens Camp presents an exciting new chapter in luxury safari experiences in the Samburu National Reserve. The camp carries the name of famed explorer Eric Larsen and honours his spirit by offering a uniquely adventurous yet luxurious escape in the very spot Larsen first pitched his camp. The camp has been in the same spot for 30 years and in the last couple of years it has re-opened under new management.

The setup of 10 luxury tents, 2 family units, and 2 deluxe luxury tented suites offers unprecedented comfort and exclusivity, wrapped in an authentic African ambiance. The private terraces of each tent offer breathtaking views of the Ewaso Nyiro River; Larsens Camp curates an unforgettable Samburu safari experience - explore, rest, and reconnect.

Luxurious tented suites each consist of a king-size bed, a writing desk, lounge sofas on the deck, a private ensuite bathroom and outdoor shower, a large wooden terrace overlooking the majestic Ewaso Nyiro and a private butler. You will have charging points in your tent, along with hot and cold running water, flushing toilet and wifi.

The main area has 24 hours power, more charging points and a swimming pool to cool off from the heat of the day.





## Thursday 10<sup>th</sup> March – 16<sup>th</sup> March



*Plenty of space to spread out and paint in camp whether by the pool or on the large deck overlooking the river.*



Each day will be discussed with Hazel over dinner the evening before.

However, the general daily schedule is as follows:

- 05:00 Early morning wake up
- 05:30 Meet for coffee and tea and a light continental breakfast.
- 06:00 Depart for morning game drive with watercolours on board, stopping for coffee midway through.
- 10:00 Return to camp for brunch.
- 11:00 Tuition with Hazel.
- 13:30 Lunch
- 14:30 Leisure – or more painting from your tent veranda.
- 15:30 Afternoon tea served on the deck overlooking the Ewaso Nyiro river.
- 16:00 Afternoon game drive and painting.
- 18:30 Return to camp
- 20:00 Dinner and retiring for bed afterward.

Whilst the focus is on painting and game viewing in the 4x4 there are options to do a guided nature walk, or a 60 minute camel ride (the Samburu use camels in their every day business), visit a local village or simply enjoy a wonderful sundowner drink out in the bush as you watch the sun set.



**Sunday 16<sup>th</sup> March**

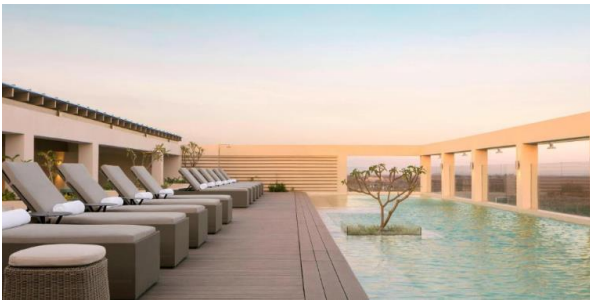

Today you will have an early morning activity before being driven back to Samburu's airstrip for your scheduled light aircraft back to Wilson Airport in Nairobi (normally around 12.10-13.15).

You will be met at Wilson Airport and driven around 30 minutes to the Four Points Sheraton Hotel in Nairobi's International Airport. Here you will have a day room each so you can choose to have lunch (payable direct) relax, have a swim on the roof terrace pool, go to the gym or have a massage.

Or, if you prefer, you can see a bit of what Nairobi has to offer as there are a couple of vehicles at our disposal this afternoon. And there are some lovely local art galleries that we could arrange for you to visit in the suburbs.

In the evening you can have some dinner (payable direct) at the hotel before you are transferred back to the international airport for your flight home:

BA 0064 – Jomo Kenyatta International Airport to London Heathrow – 23.25 – 05.40<sup>+1</sup>.

**Monday 17<sup>th</sup> March**

Arrive London Heathrow at 05.40.



*"Chief For All Time" by Hazel Soan*



Millie Summers Travel operates its holiday packages through Hemisphere Travel Group. Hemisphere Travel Group are ATOL protected (T7550) and a member of the Travel Trust Association (TTA) Q3174, giving 100% Financial Protection for all elements of your holiday.

**Cost: £8,845.00 per person**

#### **INCLUDED IN YOUR SAFARI**

- AMREF flying doctors, medical evacuation insurance.
- Road transfers, Accommodation and Domestic Flights as indicated.
- All meals and snacks at Larsens Camp (Light breakfast, brunch, afternoon tea, snacks, and dinner).
- House wines and local beverages at Larsens Camp including house wines, beer, selected spirits, soft drinks, juice, coffee, tea, and mineral water.
- Exclusive use of 2 game viewing vehicles (6 guests per car).
- Twice daily wildlife game drives and a guided naturalist walk around camp.
- Hazel's tuition and guidance for the duration of the safari.
- Laundry service.
- All reserve entrance fees and tourism levies.
- Conservation fees.
- Day room at Four Points Sheraton at Jomo Kenyatta International Airport
- Half day guided tour of Nairobi

#### **NOT INCLUDED IN YOUR SAFARI**

- International flights.
- Dinner and bar account at Tamarind Tree Hotel in Nairobi.
- Meals and bar account and any extras at Four Points Sheraton, Nairobi.
- Matters of personal nature.
- Premium brand beverages.
- Curios.
- Gratuities (tips).
- Optional activities not specified.
- Any item not specified under inclusions.
- Travel Insurance
- E-Visa



Millie Summers Travel operates its holiday packages through Hemisphere Travel Group. Hemisphere Travel Group are ATOL protected (T7550) and a member of the Travel Trust Association (TTA) Q3174, giving 100% Financial Protection for all elements of your holiday.



*The Ewaso Nyiro River can get this low in March, attracting much wildlife from all around.*

#### PAINTING SAFARI HIGHLIGHTS

- Hazel Soan as your private artist for the whole safari.
- 8 days and 7 nights of painting and tuition in situ in Samburu National Reserve in Kenya.
- Stunning location with the camp tents and main area/deck all looking over the Ewaso Nyiro River.
- Exclusive game vehicles for the group.
- Beautiful tented rooms with private deck.
- All inclusive fee (house wines and local beverages).

If you would like to discuss the itinerary or any additional add-ons to this trip then please do visit my [website](#) where you will find my [contact details](#).

Instagram: @milliesummerstravel



Millie Summers Travel operates its holiday packages through Hemisphere Travel Group. Hemisphere Travel Group are ATOL protected (T7550) and a member of the Travel Trust Association (TTA) Q3174, giving 100% Financial Protection for all elements of your holiday.